



2018 COLLECTION



"time to heat up most efficiently"

PELLET
SYSTEM
EKOLOJİK
YAKITLI
SİSTEM

FOUR
POWERFUL
ADVANTAGES
LOW COST
EASY TO
INSTALL



www.ifyil.com.tr



We are proud of producing eco-friendly
friendly products for our future.



**PELLET
SYSTEM**
SÜNLÜ DEĞER
MODERN HEATING
SOLÜSYON

**FOUR
POWERFUL
ADVANTAGES**
CENTRAL HEATING
HEAT PUMPS
WATER & EFFICIENCY



www.ifyil.com.tr

"time to heat up most efficiently"

COMPANY PROFILE Профиль Компании

Ozertechnik A.Ş. Company has been working in heating sector for 24 years and established Ifyl Termo İklmlendirme San. ve Tic. Ltd. Şti. Industry Company in 2009 for the brand name "Ifyl" offering modern innovative solutions for heating systems.

Ifyl Termo factory was established on 6.000 m² of a total area of 20.000 m². Company has already achieved an image and prestige on the market with 45 professional staff with the most modern know-how. In this regard, priorities of R & D Department of Ifyl Termo İklmlendirme are efficiency, energy saving and comfort.

Ifyl Termo already has been exporting to more than 20 countries with increasing number of demands. Ifyl quality has been embracing the world day by day with various eco-friendly models. Ifyl stoves have unique ergonomic design with its compact, modern appearance and all in one mechanical structure.

Ifyl uses the latest technology harmonizing with traditions. So, Ifyl manufactures eco-friendly pellet and wood stoves at the highest quality for international market. All the stoves are tested according to the international standards in each phase of production.

Ifyl high-tech products heat not only one room but also whole house with low fuel consumption. Besides, Ifyl high-tech products give utmost pleasure and comfort by providing hot water for its special users.

Ozertechnik Ltd Şti. уже работает в секторе отопления за 24 лет и основал Ifyl Termo İklmlendirme San. ve Tic. Ltd. Şti. в 2009 под брендом "Ifyl", и это предоставляет новые и инновационные решения для гидравлических и воздушных систем отопления на твердых и pelletным топливах.

Фабрика Ifyl Termo была основана на 6.000 м² территории 20.000 м² всего. Компания сделала имя себе в этом секторе с его 45 опытными персоналами, непрерывно сам улучшающийся идеал и его цель достигнуть лучших результатов при помощи самой современной технологии. Приоритеты отдела исследования & развития - принципы эффективности, сбережений и комфорта.

Ifyl экспортирует больше чем в 20 стран и использует удостоверенную сталь в каждом из его различных экологических модели включая все – в – одно механическое строительство, с его компактной и современной внешностью. У печей Ifyl есть уникальный дизайн и эргономическая структура.

Ifyl используя последнюю технологию, объединяя традиционные линии с современным и смешивая многосторонность с качеством, чтобы произвести экологическая продукция, полностью проверенные на каждой шаге производства.

Посредством максимальной технологии отопления не только одна комната, но также и Ваш целый дом подогреты нарушне с низким расходом топлива. К тому же, полное удовольствие системы может быть понято, когда каждый понимает, что Ваша вода также подогревается.



96100
Green Energy

IMQ
priznanstvo



TROY

HYDRO PELLETT STOVE



WWW.TIYIL.COM.IT

Eco friendly technology

экологическое отопление

- Modulation combustion • Full automatic cleaning burning pot
- Digital control panel multi-language LCD panel • Auto ignition
- Manual cleaning tubulators • Efficiently burning by powerful extractors
- Chrono (weekly) programming • Back flame safety
- Room thermostat connection • To Ambient hot air blower
- Fireplace view • Heat exchanger for hot water (optional)



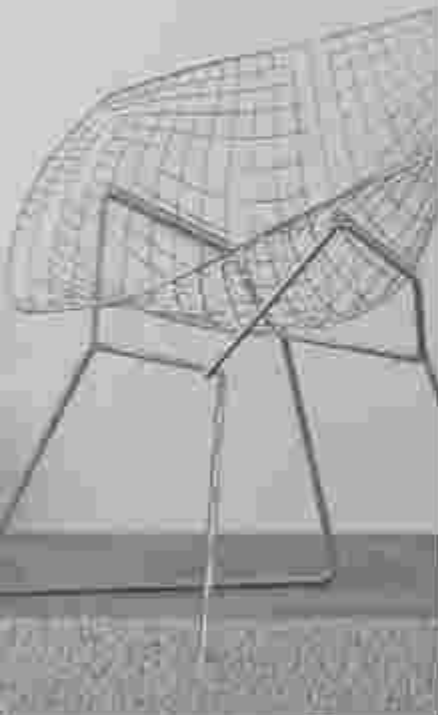

Technical Features

Measured Values

Boiler Type/ Boiler Model		Troy / Hydro Pellet Stove
Class		★★★★★
Nominal Heat Power	kW	21
Minimum Heat Power	kW	7
Heat Power to Ambient	kW	-
Hourly Fuel Consumption (min.-max.)	kg/h	1,6 - 4,9
Efficiency	%	92,5
Fuel Tank Capacity	kg	32
Chimney Gas Temperature	°C	123
Water Volume of Boiler	lt	41
Electricity Consumption	W	260
WEIGHT	Boiler Weight	kg 228
	Gross Weight (Packaged)	kg 246
DIMENSIONS	Width (W) x Length (D) x Height (H)	mm 602 x 725 x 1210
	Water Inlet - Outlets	inch 1
CONNECTIONS	Drain Pipe	inch 1/2
	Air Flow Inlet Diameter	mm Ø 60
	Chimney Outlet Diameter	mm Ø 100
Max Working Water Pressure	bar 3	
Designed Pressure	bar 3	
Test Pressure	bar 4,5	
Minimum Draught Depressure	pa 12	
Fuel Type	mm Ø 6/L30 Pellet	
Electricity Connection	Vac/Hz 230/50	
Water Heating Temperature Range	°C 60 - 80	

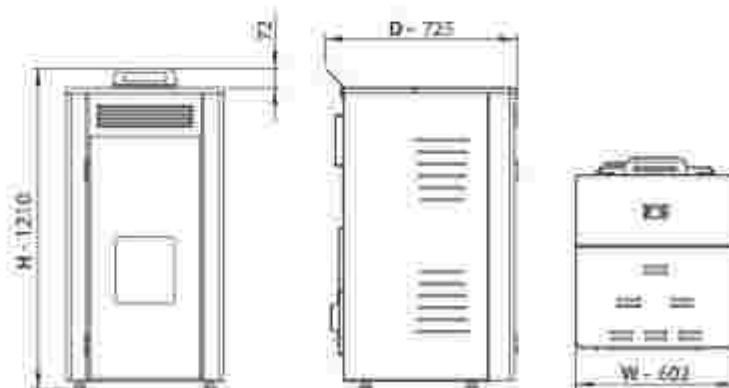

**%100
Green Energy**

IMQ
primecontrol

FREEDOOM

HYDRO PELLETT STOVE



www.ifyfl.com.tr

Reflection of
your style at home

отражение Вашего стиля дома

- Modulation combustion • Full Automatic cleaning burning pot
- Digital control panel multi language LCD panel • Auto ignition
- Manual cleaning turbulators • Efficiently burning by powerful extractors
- Chrono (weekly) programming • Back flame safety
- Room thermostat connection • Fireplace view
- Heat exchanger for hot water (optional)



Technical Features

Measured Values

Boiler Type/ Boiler Model		Freedom / Hydro Pellet Stove	
Class		★★★★★	
Nominal Heat Power	kW	15	
Minimum Heat Power	kW	5	
Heat Power to Ambient	kW	-	
Hourly Fuel Consumption (min: max)	kg/h	1,2 - 3,5	
Efficiency	%	91,8	
Fuel Tank Capacity	kg	25	
Chimney Gas Temperature	°C	121	
Water Volume of Boiler	lt	41	
Electricity Consumption	W	200	
WEIGHT	Boiler Weight	kg	226
	Gross Weight (Packaged)	kg	243,5
DIMENSIONS	Width (W) x Length (D) x Height (H)	mm	602 x 720 x 1110
	Water Inlet - Outlets	inch	1
CONNECTIONS	Drain Pipe	inch	1/2
	Air flow Inlet Diameter	mm	Ø 60
	Chimney Outlet Diameter	mm	Ø 100
Max Working Water Pressure	bar	3	
Designed Pressure	bar	3	
Test Pressure	bar	4,5	
Minimum Draught Depressure	pa	12	
Fuel Type	mm	Ø 6/130 Pellet	
Electricity Connection	Vac/Htz	230/50	
Water Heating Temperature Range	°C	60 - 80	

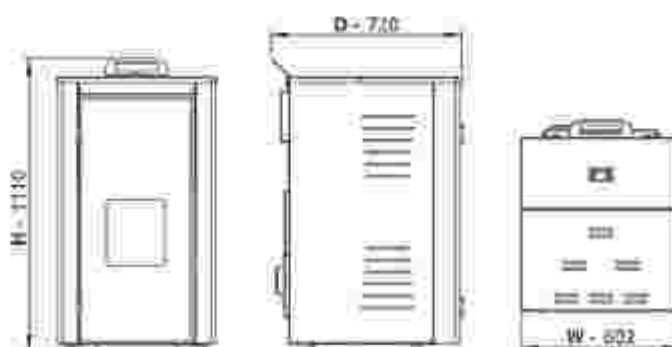

BOSPHORUS

HYDRO PELLET CUISINE STOVE



www.ifyfl.com.tr

Delicious moments cool
design and heating.

восхитительные моменты, крутой
дизайн и нагревание

- Modulation combustion - Manuel Cleaning Burning Pot
- Digital control panel multi language LCD panel - Auto ignition
- Manuel cleaning turbulators - Efficiently burning by powerfull extractors
- Chrono (weekly) programing - Back flame safety - Fireplace view.
- Room thermostat connection - Soft close oven door
- 3 floor oven - wide usefully chrome oven
- Heat exchanger for hot water (optional) - Built - In design



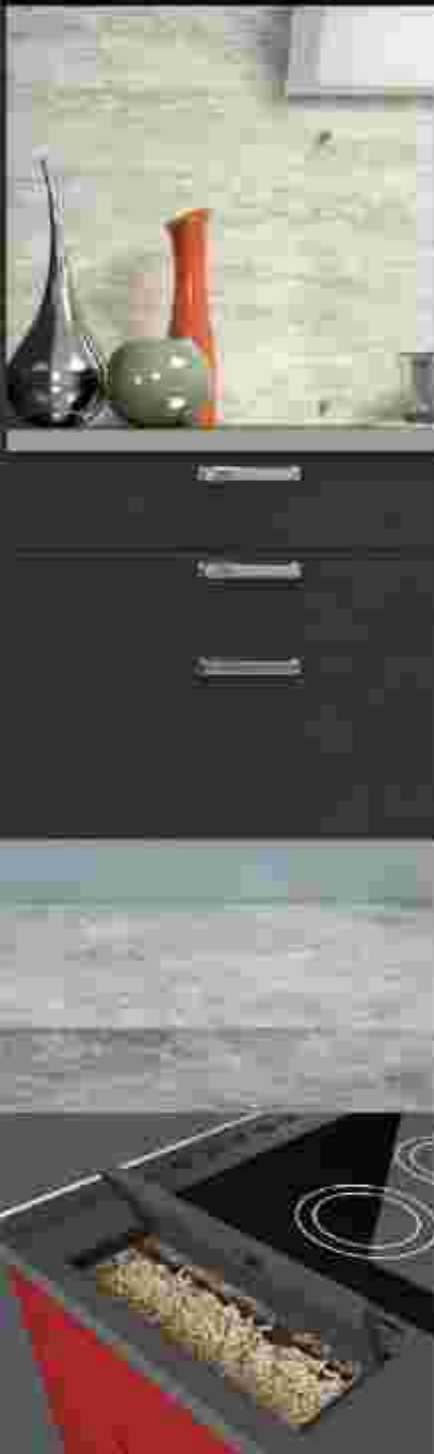

Technical Features

Boiler Type/ Boiler Model		Bosphorus / H Pellet Cuisine Stove	
Class		*****	
Nominal Heat Power	kW	13	
Minimum Heat Power	kW	4	
Heat Power to Ambient	kW	8	
Hourly Fuel Consumption (min-max)	kg/h	1,6 - 4,9	
Efficiency	%	91	
Fuel Tank Capacity	kg	26	
Chimney Gas Temperature	°C	117	
Water Volume of Boiler	lt	50	
Electricity Consumption	W	200	
WEIGHT	Boiler Weight	kg	235
	Gross Weight (Packaged)	kg	260
DIMENSIONS	Width (W) x Length (D) x Height (H)	mm	1175 x 666 x 850
	Oven Measure (W x D x H)	mm	364 x 495 x 260
CONNECTIONS	Water Inlet- Outlets	inch	1
	Drain Pipe	inch	1/2
	Air Flow Inlet Diameter	mm	Ø 60
	Chimney Outlet Diameter	mm	Ø 100
Max Working Water Pressure	bar	3	
Designed Pressure	bar	3	
Test Pressure	bar	4,5	
Minimum Draught Depressure	pa	12	
Fuel Type	mm	Ø 6/L:30 Pellet	
Electricity Connection	Vac/Hz.	230/50	
Water Heating Temperature Range	°C	60-80	

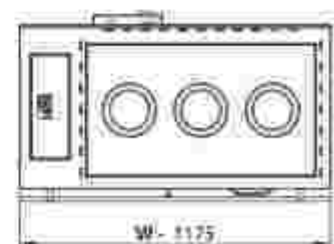
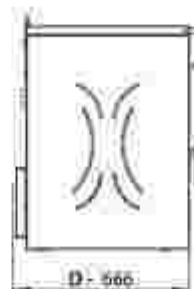
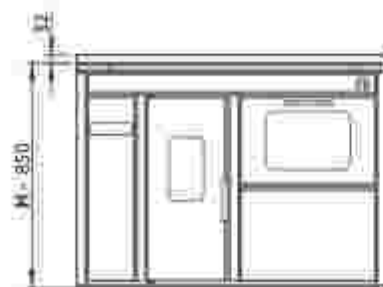

PERGAMON

PELLET FIREPLACE



www.ifyf.com.tr

Special design,
high heat capacity.

специальный дизайн, способность
высокой температуры

- Modulation combustion • Manual cleaning burning pot (brazier)
- Digital control panel multi language LCD panel • Auto ignition
- Manual cleaning turbulators • Efficiently burning by powerfull extractors
- Chrono (weekly) programing • Back flame safety
- Room thermostat connection • To ambient hot air blower
- Fireplace design • LCD view



Technical Features

Measured Values

Boiler Type/ Boiler Model		Pergamon / Pellet Fireplace	
Class		★★★★★	
Minimum Heat Power	kW	6	
Minimum Ortam Isi Gücü	kW	2	
Hourly Fuel Consumption (min-max)	kg/h	0,4 - 1,2	
Efficiency	%	90,2	
Fuel Tank Capacity	kg	20	
Chimney Gas Temperature	°C	196	
Heating Volume	m ³	150	
Electricity Consumption	W	200	
WEIGHT	Boiler Weight	kg	85
	Weight Strong Stand	kg	28
	Gross Weight (Packaged)	kg	110±28
DIMENSIONS	Width (W) x Length (D) x Height (H)	mm	980 x 398 x 700
	Strong Stand - (W x D x H)	mm	905 x 315 x 500
CONNECTIONS	Water Inlet - Outlet	inch	-
	Air Flow Inlet Diameter	mm	Ø 50
	Chimney Outlet Diameter	mm	Ø80
Minimum Draught Depressure	pa	12	
Fuel Type	mm	Ø 6/L-30 Pellet	
Electricity Connection	Vac/Hz:	230/50	

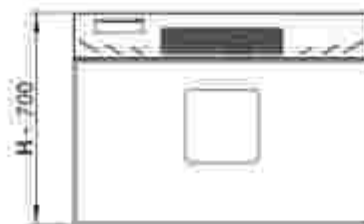
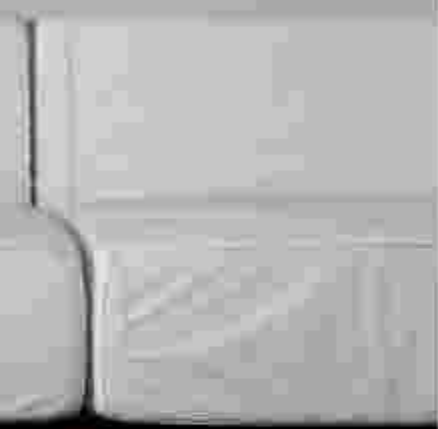

CRYSTAL

AIR PELLET STOVE



www.ifyfl.com.tr

For high quality
living spaces.

для высококачественных живущих мест

- Modulation combustion • Manual cleaning burning pot (brazier)
- Digital control panel multi language LCD panel • Auto ignition
- Manual cleaning turbulators • Efficiently burning by powerful extractors
- Chrono (weekly) programming • Back flame safety
- Room thermostat connection • To ambient hot air blower
- Fireplace view • Multi places heating



Technical Features

Measured Values

Boiler Type/ Boiler Model		Crystal / Air Pellet Stove	
Class		★★★★★	
Nominal Heat Power	kW	12	
Minimum Heat Power	kW	4	
Hourly Fuel Consumption (min.-max.)	kg/h	0,8 - 2,5	
Efficiency	%	90,5	
Fuel Tank Capacity	kg	21	
Chimney Gas Temperature	°C	192	
Heating Volume	m ³	300	
Electricity Consumption	W	200	
WEIGHT	Boiler Weight	kg	120
	Gross Weight (Packaged)	kg	138
DIMENSIONS	Width (W) x Length (D) x Height (H)	mm	490 x 634 x 1105
	Air Flow Inlet Diameter	mm	Ø50
CONNECTIONS	Chimney Outlet Diameter	mm	Ø80
	Minimum Draught Depressure	pa	12
Fuel Type	mm	Ø 6/1,30 Pellet	
Electricity Connection	Vac/Hz:	230/50	

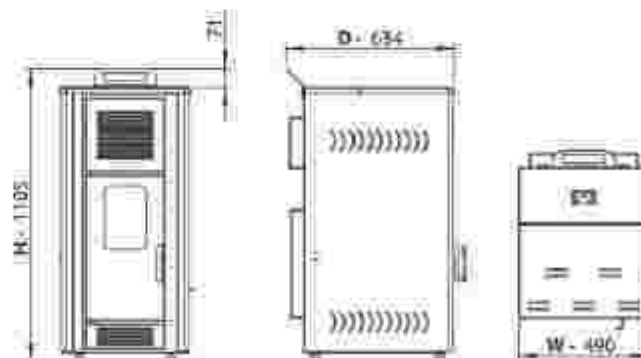

THERMAL

AIR PELLETT STOVE



www.tfyf.com.tr

Smart designs for your
needs and comfort

умные дизайны для Ваших
потребностей и комфорта

- Modulation combustion • Manual cleaning burning pot (brazier)
- Digital control panel multi language LCD panel • Auto Ignition
- Manual cleaning turbulators • Efficiently burning by powerfull extractors
- Chrono (weekly) programing • Back flame safety • Fireplace view
- Room thermostat connection • To ambient hot air blower



Technical Features

Measured Values

Boiler Type/ Boiler Model		Thermal / Air Pellet Stove	
Class		★★★★★	
Nominal Heat Power	kW	8	
Minimum Heat Power	kW	2,5	
Hourly Fuel Consumption (min.-max.)	kg/h	0,8-1,7	
Efficiency	%	91	
Fuel Tank Capacity	kg	15	
Chimney Gas Temperature	°C	182	
Heating Volume	m ³	175	
Electricity Consumption	W	200	
AGIRLIK	Boiler Weight	kg	110
	Gross Weight (Packaged)	kg	128
BOYUTLAR	Width (W) x Length (D) x Height (H)	mm	490 x 634 x 1033
BAGLANTILAR	Air Flow Inlet Diameter	mm	Ø50
	Chimney Outlet Diameter	mm	Ø80
Minimum Draught Depressure	pa	12	
Fuel Type	mm	Ø 6/1,30 Pellet	
Electricity Connection	Vac/Hz:	230/50	

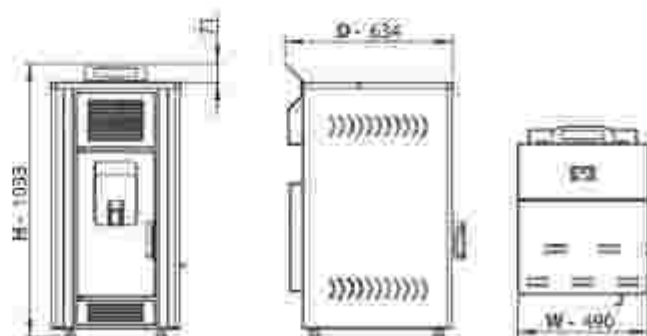

ROASTER

SOLID FUEL HYDRO CUISINE STOVE



www.ifyfl.com.tr

Useful and practical
for all living spaces

полезные и практические решения
во всех живущих мест

- Hydraulic ready system (Circulation pump, safety valves, thermostat, airflow controller and connections) • Oven for cooking • Fireplace View
- Cooking surfaces top on stove • Easy-move cast iron grate
- To burn wood, coal and briquette • Thermal safety valve
- Semi auto airflow controller (40 °C - 80 °C) • Manual secondary air



FOUR
POWERFUL
ADVANTAGES
CENTRAL HEATING
HOT WATER
W/D & B.P. REPLACE



Technical Features

Measured Values

Boiler Type/ Boiler Model		Roaster / Hydro Cuisine Stove	
Class		★★★★★	
HEAT POWER to WATER	Coal	kW	28
	Wood	kW	20
	Briquette	kW	23
HEAT POWER to AMBIENT	Coal	kW	4
	Wood	kW	4
	Briquette	kW	6
Minimum Draught Depressure		pa	18
Efficiency		%	80
Water Volume of Boiler		lt	39
WEIGHT	Boiler Weight	kg	205
	Gross Weight (Packaged)	kg	223
DIMENSIONS	Width (W) x Length (D) x Height (H)	mm	630 x 732 x 1145
	Oven Measure (W x D x H)	mm	320 x 480 x 175
CONNECTIONS	Water Inlet - Outlets	inch	1
	Expansion Line, to Expansion Tank and Return	inch	3/4
	Chimney Outlet Diameter	mm	Ø 130
Max Working Water Pressure		bar	2
Designed Pressure		bar	2
Test Pressure		bar	4
Electricity Consumption		W	45
Electricity Connection		Vac/Hz	230/50
Water Heating Temperature Range		°C	40 - 80
Fuel Type		Wood, Coal, Briquette	
Fuel Loading Place		Front Load	
Primary Airflow Control		Automatic	
Secondary Airflow Control		Manual	



Eco Friendly

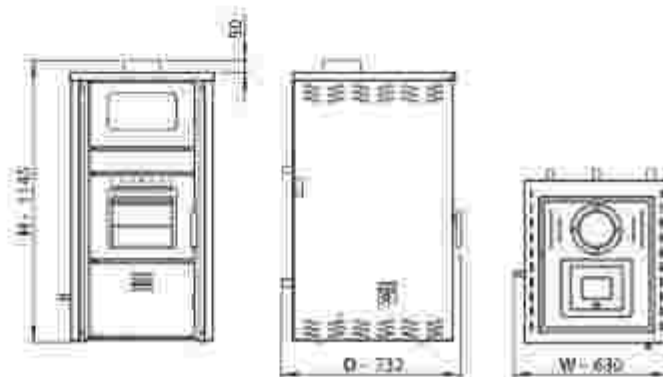

SUPERNOVA

SOLID FUEL HYDRO STOVE



www.ifytl.com.tr

Just enjoy
the pleasure

просто наслаждайтесь удовольствием

- Hydraulic ready system (Circulation pump, safety valves, thermostat, airflow controller and connections) • Easy-move cast iron grate
- Cooking surfaces top on stove • Fireplace View
- To burn wood, coal and briquette • Thermal safety valve
- Semi auto airflow controller (40 °C - 80 °C) • Manual secondary air



FOUR
POWERFUL
ADVANTAGES
CENTRAL HEATING
HOT WATER
H.T.O. & B.T. REPLACE



Technical Features

Measured Values

Boiler Type/ Boiler Model		Supernova / Hydro Stove	
Class		★★★★★	
HEAT POWER to WATER	Coal	kW	34
	Wood	kW	25
	Briquette	kW	28
HEAT POWER to AMBIENT	Coal	kW	4
	Wood	kW	4
	Briquette	kW	6
Minimum Draught Depressure		pa	18
Efficiency		%	80
Water Volume of Boiler		lt	64
WEIGHT	Boiler Weight	kg	210
	Gross Weight (Packaged)	kg	228
DIMENSIONS	Width (W) x Length (D) x Height (H)	mm	607 x 720 x 1160
CONNECTIONS	Water Inlet - Outlets	inch	1
	Expansion Line, to Expansion Tank and Return	inch	3/4
	Chimney Outlet Diameter	mm	Ø 130
Max Working Water Pressure		bar	2
Designed Pressure		bar	2
Test Pressure		bar	4
Electricity Consumption		W	45
Electricity Connection		Vac/Hz	230/50
Water Heating Temperature Range		°C	40 - 80
Fuel Type		Wood, Coal, Briquette	
Fuel Loading Place		Front Load	
Primary Airflow Control		Automatic	
Secondary Airflow Control		Manual	



Eco Friendly

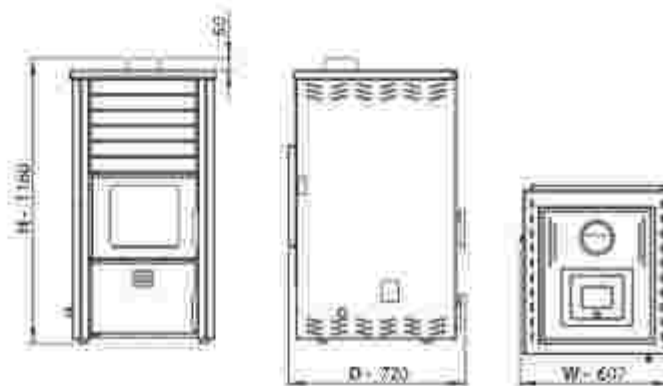

STAR

SOLID FUEL HYDRO CUISINE STOVE



www.fyfl.com.tr

Large cooker with unique tastes

большая плита с уникальными вкусами

- Hydraulic ready system (Circulation pump, safety valves, thermostat, airflow controller and connections) • Oven for cooking • Fireplace View
- Cooking surfaces top on stove • Easy-move cast iron grate
- To burn wood, coal and briquette • Thermal safety valve
- Semi auto airflow controller (40 °C - 80 °C) • Manuel secondary air
- Optional chimney outputs diameters 130 mm - 150 mm



FOUR
POWERFUL
ADVANTAGES
CENTRAL HEATING
HOT WATER
H.T.O. & B.T. REPLACE



Technical Features

Measured Values

Boiler Type/ Boiler Model		Star / Hydro Cuisine Stove	
Class		★★★★★	
HEAT POWER to WATER	Coal	kW	28
	Wood	kW	20
	Briquette	kW	23
HEAT POWER to AMBIENT	Coal	kW	6
	Wood	kW	6
	Briquette	kW	6
Minimum Draught Depressure		pa	18
Efficiency		%	80
Water Volume of Boiler		lt	39
WEIGHT	Boiler Weight	kg	287
	Gross Weight (Packaged)	kg	309
DIMENSIONS	Width (W) x Length (D) x Height (H)	mm	1162 x 732 x 921
	Oven Measure (W x D x H)	mm	367 x 498 x 260
CONNECTIONS	Water Inlet - Outlets	inch	1
	Expansion Line, to Expansion Tank and Return	inch	3/4
	Chimney Outlet Diameter	mm	Ø 150
Max Working Water Pressure		bar	2
Designed Pressure		bar	2
Test Pressure		bar	4
Electricity Consumption		W	45
Electricity Connection		Vac/Hz	230/50
Water Heating Temperature Range		°C	40 - 80
Fuel Type		Wood, Coal, Briquette	
Fuel Loading Place		Top Load - Front Load	
Primary Airflow Control		Automatic	
Secondary Airflow Control		Manual	



Eco Friendly

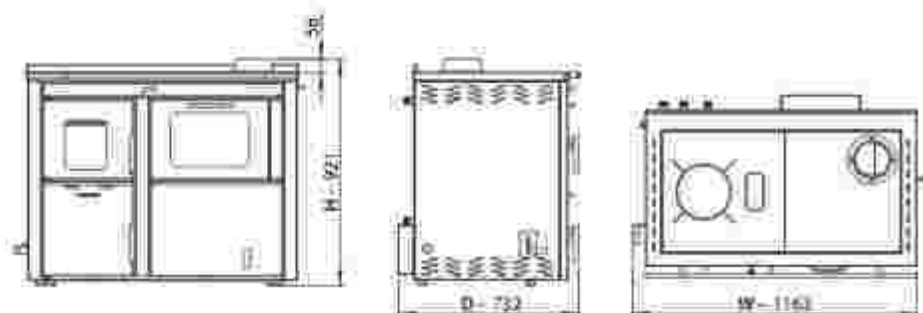

SAUNA

SOLID FUEL HYDRO STOVE



www.stylit.com.tr

Minimum fuel maximum heating

МИНИМУМ ТОПЛИВО, МАКСИМУМ ОТОПЛЕНИЕ

- Hydraulic ready system (Circulation pump, safety valves, thermostat, airflow controller and connections) • Easy-move cast iron grate
- Cooking surfaces top on stove • Fireplace View
- To burn wood, coal and briquette • Thermal safety valve
- Semi auto airflow controller (40 °C - 80 °C) • Manuel secondary air



FOUR
POWERFUL
ADVANTAGES
CENTRAL HEATING
HOT WATER
HTR & BTR REPLACE



Technical Features

Measured Values

Boiler Type/ Boiler Model		Sauna / Hydro Cuisine Stove	
Class		★★★★★	
HEAT POWER to WATER	Coal	kW	23
	Wood	kW	17
	Briquette	kW	19
HEAT POWER to AMBIENT	Coal	kW	6
	Wood	kW	4
	Briquette	kW	6
Minimum Draught Depressure		pa	18
Efficiency		%	80
Water Volume of Boiler		lt	39
WEIGHT	Boiler Weight	kg	165
	Gross Weight (Packaged)	kg	183
DIMENSIONS	Width (W) x Length (D) x Height (H)	mm	639 x 732 x 872
CONNECTIONS	Water Inlet - Outlets	inch	1
	Expansion Line, to Expansion Tank and Return	inch	3/4
	Chimney Outlet Diameter	mm	Ø 130
Max Working Water Pressure		bar	2
Designed Pressure		bar	2
Test Pressure		bar	4
Electricity Consumption		W	45
Electricity Connection		Vac/Hz	230/50
Water Heating Temperature Range		°C	40 - 80
Fuel Type		Wood, Coal, Briquette	
Fuel Loading Place		Top Load	
Primary Airflow Control		Automatic	
Secondary Airflow Control		Manual	

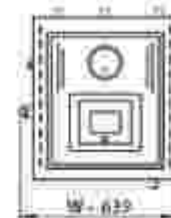
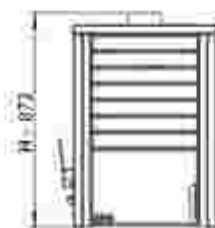

HAMMAM

SOLID FUEL HYDRO STOVE



www.ifyll.com.tr

Smaller in size
greater in efficiency

меньше в размере, больше в эффективности

- Hydraulic ready system (Circulation pump, safety valves, thermostat, airflow controller and connections) • Easy-move cast iron grate
- Cooking surfaces top on stove • Fireplate View
- To burn wood, coal and briquette • Thermal safety valve
- Semi auto airflow controller (40 °C - 80 °C) • Manuel secondary air



FOUR
POWERFUL
ADVANTAGES
CENTRAL HEATING
HOT WATER
WTO & B.T. REPLACE



Technical Features

Measured Values

Boiler Type/ Boiler Model		Hamnam / Hydro Cuisine Stove	
Class		★★★★★	
HEAT POWER to WATER	Coal	kW	23
	Wood	kW	17
	Briquette	kW	19
HEAT POWER to AMBIENT	Coal	kW	6
	Wood	kW	4
	Briquette	kW	6
Minimum Draught Depressure		pa	18
Efficiency		%	80
Water Volume of Boiler		lt	39
WEIGHT	Boiler Weight Weight	kg	160
	Gross Weight (Packaged)	kg	178
DIMENSIONS	Width (W) x Length (D) x Height (H)	mm	639 x 732 x 892
CONNECTIONS	Water Inlet - Outlets	inch	1
	Expansion Line, to Expansion Tank and Return	inch	3/4
	Chimney Outlet Diameter	mm	Ø 130
Max Working Water Pressure		bar	2
Designed Pressure		bar	2
Test Pressure		bar	4
Electricity Consumption		W	45
Electricity Connection		Vac/Hz	230/50
Water Heating Temperature Range		°C	40 - 80
Fuel Type		Wood, Coal, Briquette	
Fuel Loading Place		Front Load	
Primary Airflow Control		Automatic	
Secondary Airflow Control		Manual	



Eco Friendly

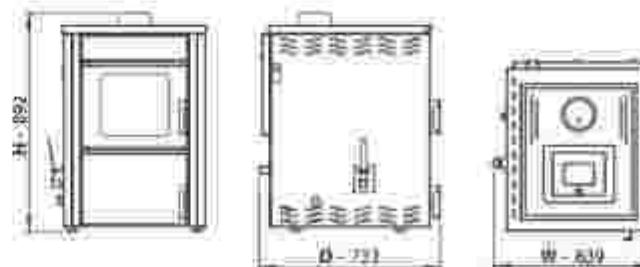

PELLET GT15

PELLET BOILER



www.ifyil.com.tr

- Modulation combustion • Full automatic cleaning burning pot
- Digital control panel multi language LCD panel • Auto ignition
- Manual cleaning turbulators • Efficiently burning by powerfull extractors
- Chrono (weekly) programming • Back flame safety
- Room thermostat connection • Heat exchanger for hot water (optional)



Teknik Özellikler

Ölçülen Değerler

Boiler Type/ Boiler Model		Pellet GT 15 / Pellet Boiler	
Class		★★★★★	
Nominal Heat Power	kW	15	
Minimum Heat Power	kW	5	
Hourly Fuel Consumption (min.-max.)	kg/h	1,2 - 3,5	
Efficiency	%	91,5	
Fuel Tank Capacity	kg	40	
Chimney Gas Temperature	°C	112	
Water Volume of Boiler	lt	41	
Electricity Consumption	W	200	
WEIGHT	Boiler Weight	kg	230
	Gross Weight (Packaged)	kg	235
DIMENSIONS	Width (W) x Length (D) x Height (H)	mm	604 x 793 x 1257
	Water Inlet - Outlets	inch	1
CONNECTIONS	Drain Pipe	mm	Ø 60
	Chimney Outlet Diameter	mm	Ø 100
Max Working Water Pressure	bar	3	
Designed Pressure	bar	3	
Test Pressure	bar	4,5	
Minimum Draught/Depressure	pa	12	
Fuel Type	mm	Ø 6/L:30 Pellet	
Electricity Connection	Vac/Hz.	230/50	
Water Heating Temperature Range	°C	60 - 80	



Pellet Fuel



%100
Green Energy

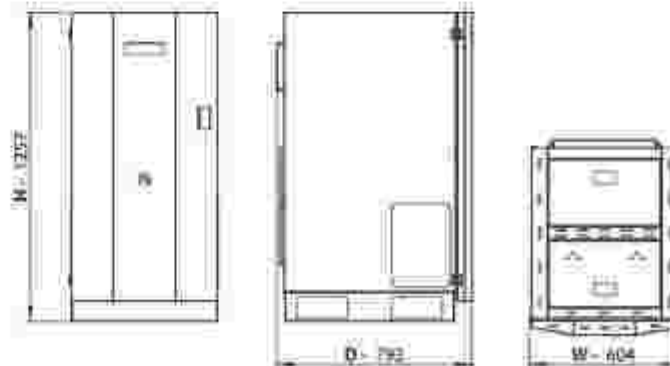

PELLET GT25

PELLET BOILER



www.ifyil.com.tr

- Modulation combustion • Full automatic cleaning burning pot
- Digital control panel multi language LCD panel • Auto ignition
- Manual cleaning turbulators • Efficiently burning by powerfull extractors
- Chrono (weekly) programming • Back flame safety
- Room thermostat connection • Heat exchanger for hot water (optional)



Teknik Özellikler

Ölçülen Değerler

Boiler Type/ Boiler Model		Pellet GT 25 / Pellet Boiler	
Class		★★★★★	
Nominal Heat Power	kW	25	
Minimum Heat Power	kW	6,3	
Hourly Fuel Consumption (min.-max.)	kg/h	1,9-5,8	
Efficiency	%	91,5	
Fuel Tank Capacity	kg	50	
Chimney Gas Temperature	°C	119	
Water Volume of Boiler	lt	72	
Electricity Consumption	W	200	
WEIGHT	Boiler Weight	kg	273
	Gross Weight (Packaged)	kg	278
DIMENSIONS	Width (W) x Length (D) x Height (H)	mm	604 x 901 x 1367
	Water Inlet - Outlets	inch	1
CONNECTIONS	Drain Pipe	mm	Ø 60
	Chimney Outlet Diameter	mm	Ø 100
Max Working Water Pressure	bar	3	
Designed Pressure	bar	3	
Test Pressure	bar	4,5	
Minimum Draught/Depressure	pa	12	
Fuel Type	mm	Ø 6/L:30 Pellet	
Electricity Connection	Vac/Hz.	230/50	
Water Heating Temperature Range	°C	60-80	



Pellet Fuel



%100
Green Energy

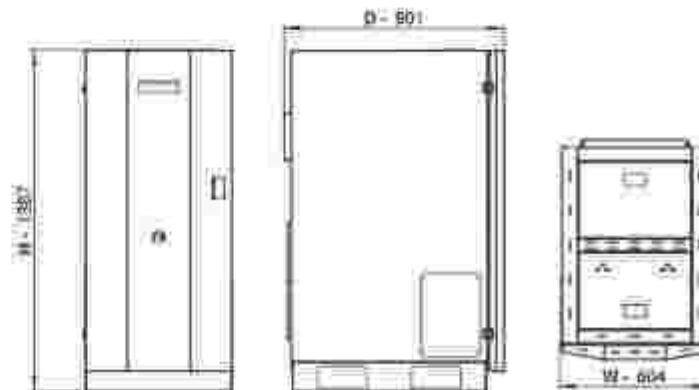

PELLET GT40

PELLET BOILER



www.ifyil.com.tr

- Modulation combustion • Full automatic cleaning burning pot
- Digital control panel multi language LCD panel • Auto ignition
- Manual cleaning turbulators • Efficiently burning by powerful extractors
- Chrono (weekly) programming • Back flame safety
- Room thermostat connection



Teknik Özellikler

Ölçülen Değerler

Boiler Type/ Boiler Model		Pellet GT 40 / Pellet Boiler	
Class		★★★★★	
Nominal Heat Power	kW	40	
Minimum Heat Power	kW	14	
Hourly Fuel Consumption (min.-max.)	kg/h	3,1-9,4	
Efficiency	%	91,5	
Fuel Tank Capacity	kg	340	
Chimney Gas Temperature	°C	131	
Water Volume of Boiler	lt	120	
Electricity Consumption	W	260	
WEIGHT	Boiler Weight	kg	388
	Fuel Tank Weight	kg	103
	Gross Weight (Packaged)	kg	500
DIMENSIONS	Width (W) x Length (D) x Height (H)	mm	800 x 1131 x 1285
	Fuel Tank (W x D x H)	mm	503 x 1430 x 1475
CONNECTIONS	Water Inlet- Outlets	inch	1
	Drain Pipe	mm	Ø 60
	Chimney Outlet Diameter	mm	Ø 130
Max Working Water Pressure	bar	3	
Designed Pressure	bar	3	
Test Pressure	bar	4,5	
Minimum Draught Depressure	pa	12	
Fuel Type	mm	Ø 6/LL30 Pellet	
Electricity Connection	Vac/Hz	230/50	
Water Heating Temperature Range	°C	60-80	



Pellet Fuel



%100
Green Energy

IMQ
primasert

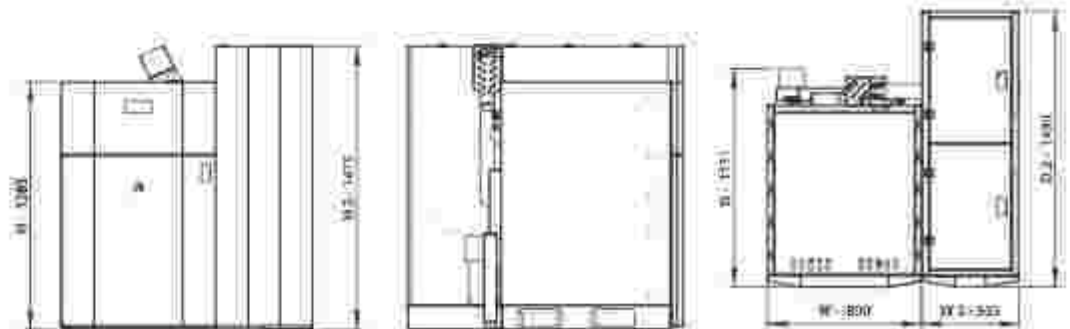

PELLET GT60

PELLET BOILER



www.iffa.com.tr

- Modulation combustion • Full automatic cleaning burning pot
- Digital control panel multi language LCD panel • Auto ignition
- Manual cleaning turbulators • Efficiently burning by powerful extractors
- Chrono (weekly) programming • Back flame safety
- Room thermostat connection



Teknik Özellikler

Ölçülen Değerler

Boiler Type/ Boiler Model		Pellet G3 60 / Pellet Boiler	
Class		*****	
Nominal Heat Power	kW	60	
Minimum Heat Power	kW	20	
Hourly Fuel Consumption (min-max.)	kg/h	4,6 - 14	
Efficiency	%	92	
Fuel Tank Capacity	kg	340	
Chimney Gas Temperature	°C	116	
Water Volume of Boiler	lt	150	
Electricity Consumption	W	260	
WEIGHT	Boiler Weight	kg	418
	Fuel Tank Weight	kg	103
	Gross Weight (Packaged)	kg	532
DIMENSIONS	Width (W) x Length (D) x Height (H)	mm	800 x 1133 x 1475
	Fuel Tank (W x D x H)	mm	503 x 1430 x 1475
CONNECTIONS	Water Inlet- Outlets	inch	1
	Drain Pipe	mm	Ø 63
	Chimney Outlet Diameter	mm	Ø 130
Max Working Water Pressure	bar	3	
Designed Pressure	bar	3	
Test Pressure	bar	4,5	
Minimum Draught Depressure	pa	12	
Fuel Type	mm	Ø 6/1,30 Pellet	
Electricity Connection	Vac/Hz	230/50	
Water Heating Temperature Range	°C	60 - 80	



Pellet Fuel



%100
Green Energy

IMQ
primocert.it



"ifyil for healthy future at high quality living spaces"

"ifyil- для улучшения здоровья и качества жилого пространства"



**IFYIL STOVES
COLOR OPTIONS**

-  Dark Red / Темно-красный
-  Dark Green / Темно-зеленый
-  Grey / Серый



Open Expansion
открытый
расширительный бак



Closed Expansion
закрытый
расширительный бак

Economical and Comfortable

Fuel cost of IFYIL stoves are approximately the same as the fuel cost of normal stoves. In comparison to a normal stove, IFYIL stove enables heating all house at an equal rate with the help of radiators. Hence, hot water is provided for kitchen and bathroom while all house is equally heated.

Экологические и Удобные...

Самостоятельность топлива в печи "ifyil" почти одинакова с самостоятельностью обыкновенных печей. Отличие печей "ifyil" - они обогревают в 5 раз большую площадь, чем обыкновенные печи. Обогревают равномерно весь дом, у вас будет возможность наслаждаться использованием горячей воды в кухне и в ванной!

THE SUITABLE CHIMNEY DIAGRAM FOR IFYIL STOVES

Схема дымохода для печей "ifyil"

The roof ridging min. 80 cm
Крыша должна быть min. 80 см

The ideal width of the chimney 13-18 cm
внутренний диаметр дымохода составляет 13-18 см

Space in this area needs to be filled, so as not to penetrate the air

Пространство между стеной и дымоходом должно быть заполнено чтобы не проникать воздух

Standard diameter of chimney 13 cm and with an elbow

Труба печи должна составлять 13 см как стандарт с одним локтем



Pellet Boiler Digital Control Panel

Pellet Stove Digital Control Panel

IFYIL STOVES OPTIONAL SPARE PARTS



Heat Exchanger (16 plate)



Ifyil Towel radiator (Not isolated) 65lt



Ifyil Water heater (boiler) with electrical heating



RS 25/6

Wilo Yonos Para Frequency control circulation pump



RS 25/7.5

Wilo Yonos Para Frequency control circulation pump



Thermal Safety Valve



Tempered glass 10 mm 70 cm x 90 cm



Tempered glass 10 mm 75 cm x 90 cm



Ash Vacuum Cleaner



Anti-Condense Valve



Voltage Regulator



Ifyil Flex set with heat exchanger (5 and 7 parts)

IFYIL Stove Detail

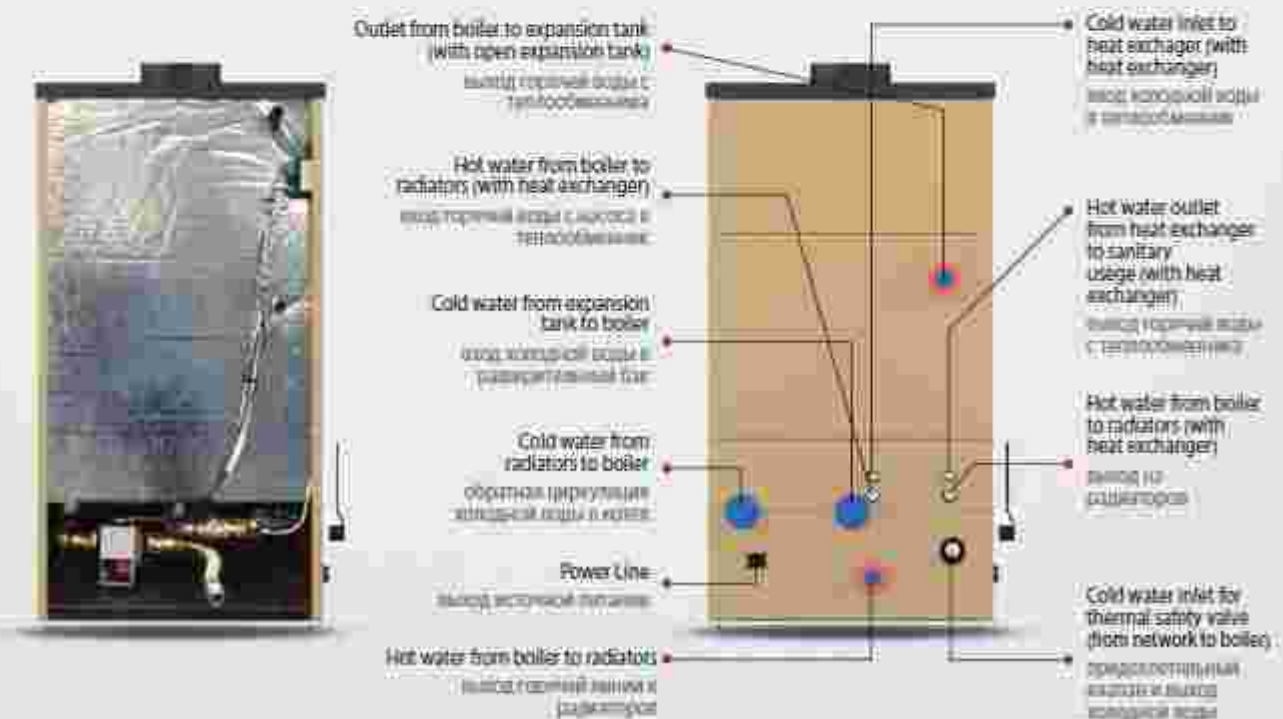
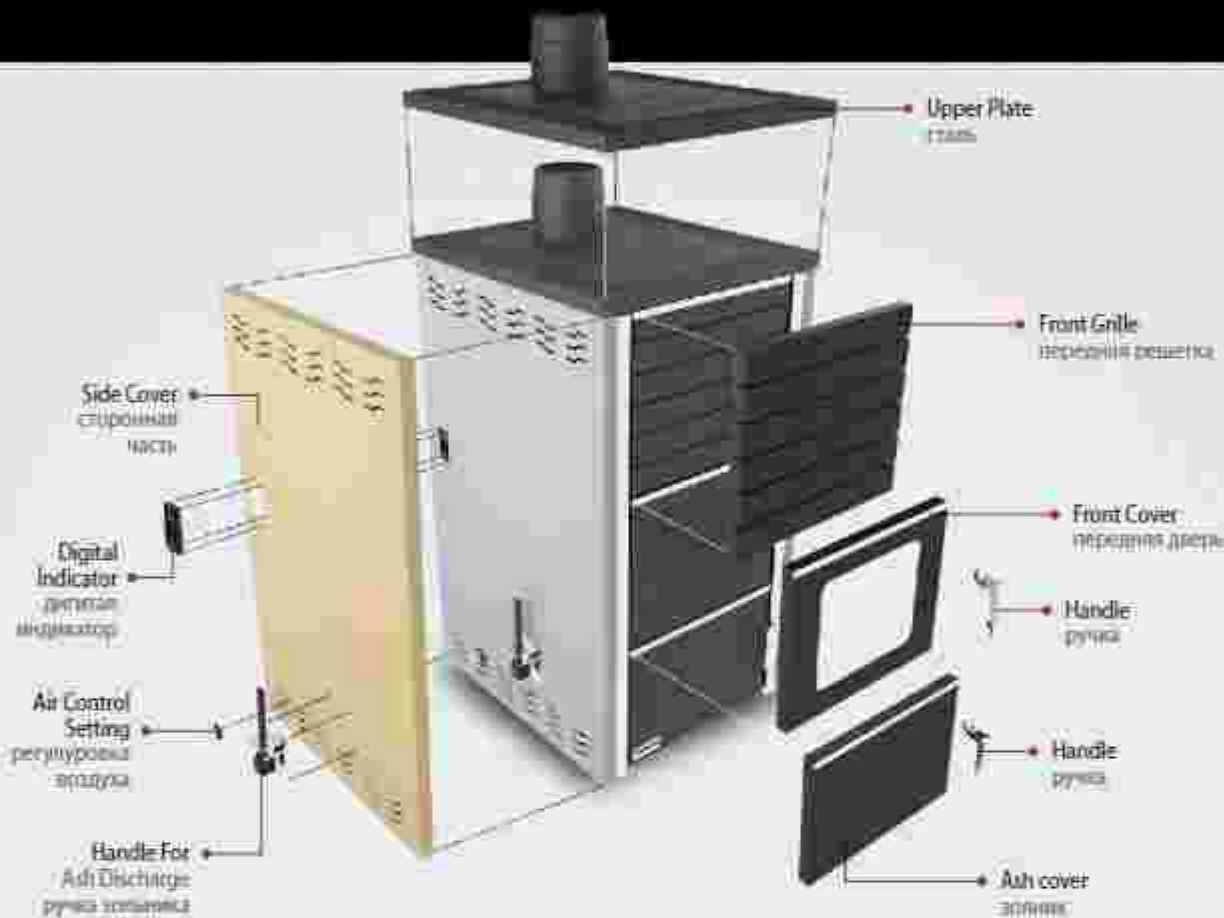

"time to heat up most efficiently"



With more than 24 years experience on market, **exporting to 20 countries**

İfyıl continues its quality service approach with its power of 24 years experience and experienced expert staff in the heating sector to 20 countries with its exports on the world market.





"time to heat up most efficiently"



PELLET
SYSTEM

SMALL DESIGN
ECONOMY / EFFICIENT
SOLUTIONS

FOUR
POWERFUL
ADVANTAGES

CONTROL HEATING
NOT NEEDED
EASY & AFFORDABLE



Ifyil is not responsible for typographic mistakes and discolorations. ifyil reserves the right to make changes to its products at any/ye time.
мы не несем ответственности за типографские ошибки и окрашиваемые потери на каталоге. Ifyil держит свои права тайно, чтобы изменить продукты.



100%
Green Energy

IMQ
premier







İFYİL "time to heat up most efficiently"

2018 COLLECTION

İFYİL TERMO İklimlendirme San. ve Tic. Ltd. Şti.
Kavak Organize Sanayi Bölgesi 3. Cad. No.11 Kavak / Samsun / Turkey
+90 362 431 41 10 - 30 fax +90 362 432 80 43 info@ifyil.com.tr



www.ifyil.com.tr

